

ART & DESIGN West

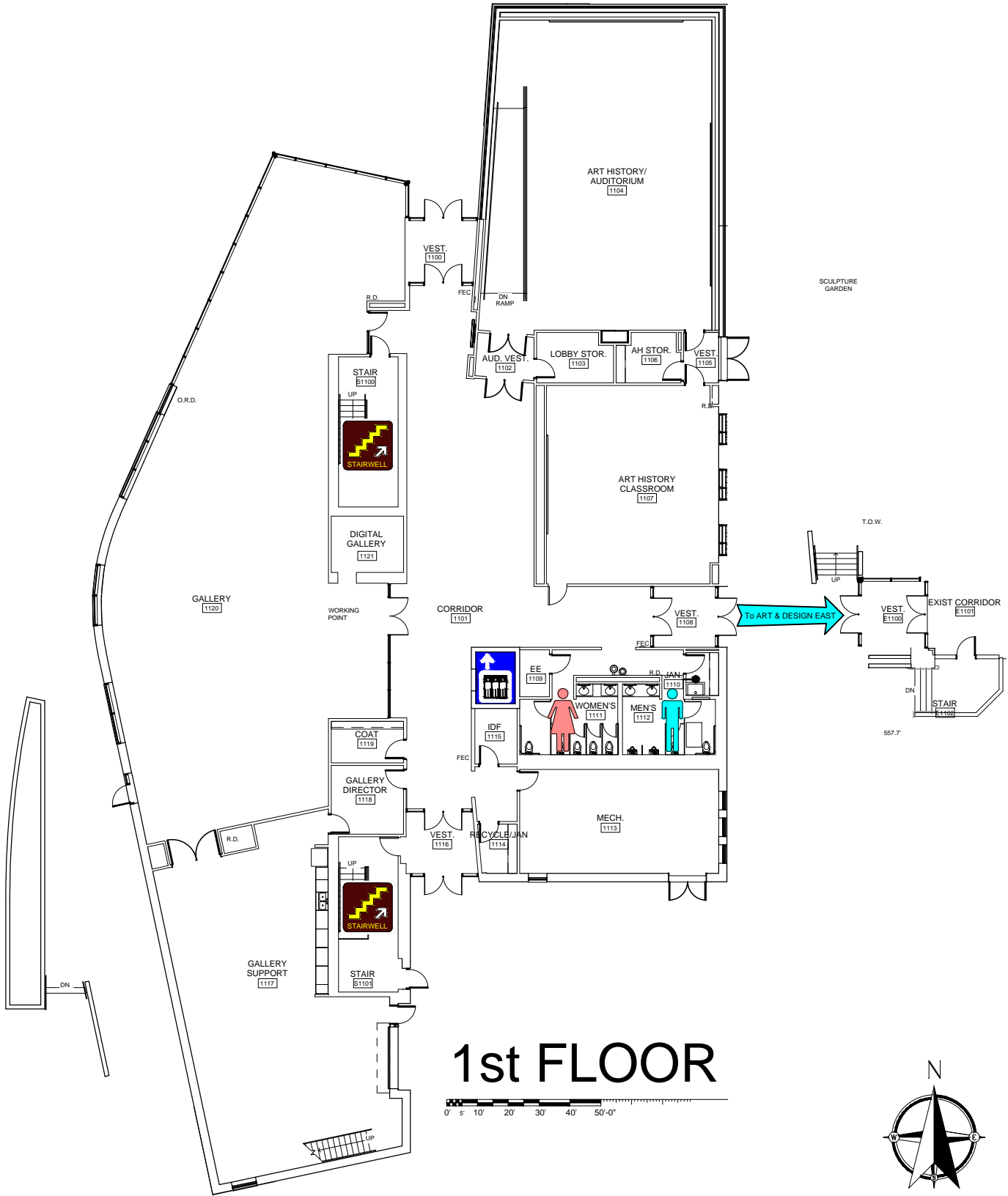

1st FLOOR

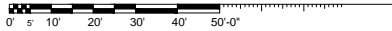

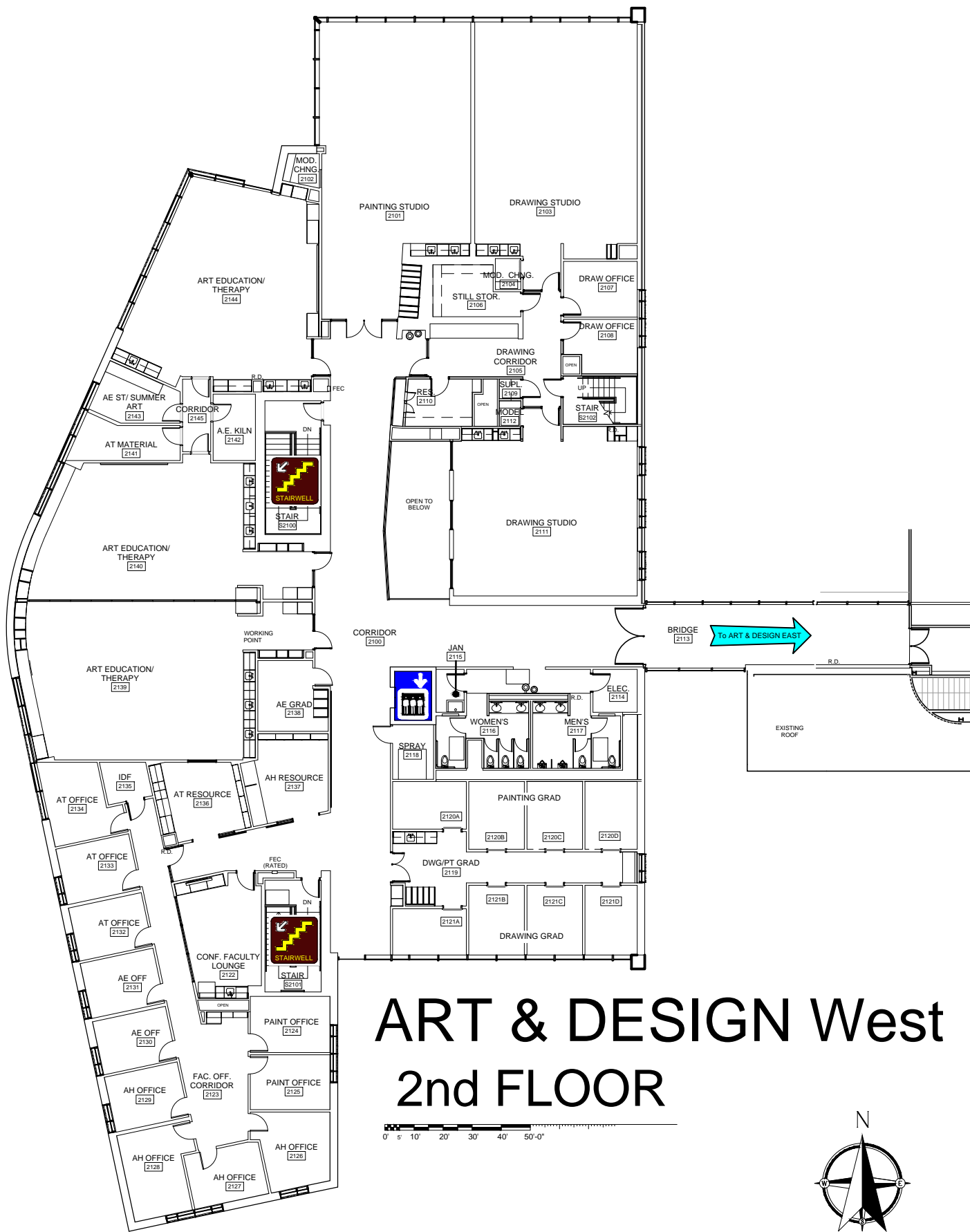

PAINTING STUDIO
2101

DRAWING STUDIO
2103

ART EDUCATION/
THERAPY
2144

MOD. CHNG.
2104
STILL STOR.
2106

DRAW OFFICE
2107

DRAW OFFICE
2108

AE ST/ SUMMER
ART
2143

CORRIDOR
2145

A.E. KILN
2142

AT MATERIAL
2141

STAIRWELL
2100
STAIR
S2100

DRAWING
CORRIDOR
2105

RES
2110

SUPL
2105

MODE
2112

UP
STAIR
S2102

OPEN TO
BELOW

DRAWING STUDIO
2111

ART EDUCATION/
THERAPY
2140

ART EDUCATION/
THERAPY
2139

WORKING
POINT

CORRIDOR
2100

BRIDGE
2113

To ART & DESIGN EAST

EXISTING
ROOF

AT OFFICE
2134

IDF
2135

AT RESOURCE
2136

AH RESOURCE
2137

AT OFFICE
2133

AT OFFICE
2132

AT OFFICE
2131

AE OFF
2131

AE OFF
2130

AH OFFICE
2129

AH OFFICE
2128

AH OFFICE
2127

CONF. FACULTY
LOUNGE
2122

STAIRWELL
2100
STAIR
S2100

PAINT OFFICE
2124

PAINT OFFICE
2125

AH OFFICE
2126

JAN
2115

SPRAY
2118

WOMEN'S
2116

MEN'S
2117

ELEC.
2114

PAINTING GRAD

2120A

2120B

2120C

2120D

DWG/PT GRAD
2119

2121A

2121B

2121C

2121D

DRAWING GRAD

EMERGENCY STORM SHELTERS

In event of a Tornado Warning everyone should go to a Lower Level **Primary Storm Shelter**

In event you can not get to a Primary Shelter go to a **Secondary Storm Shelter**

ART & DESIGN West

